

# DOUGLASS CEMETERY

1408 SW Hensley Rd, Troutdale

Established 1866

Amidst wide swaths of lawn, a grove of Douglas firs offers a woodland feel and a beautiful place for reflection. At 9.1 acres of lawn and forest, Douglass is one of Metro's larger cemeteries. There is a designated burial section available for the Jewish community.



Metro

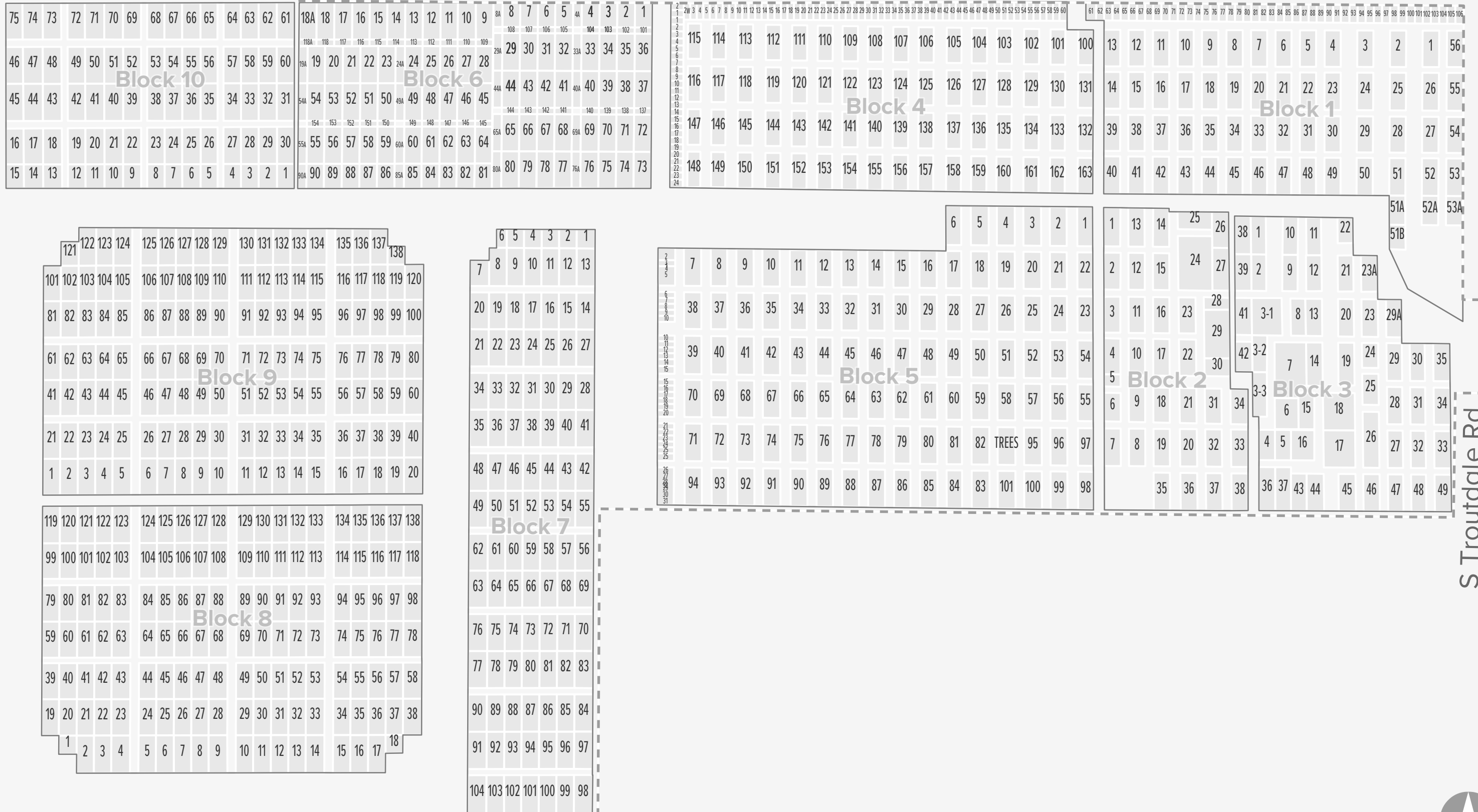

During inclement weather, please check [oregonmetro.gov/cemeteries](http://oregonmetro.gov/cemeteries) for information about any closures.

0 50 100 Feet

Map published: 11/14/2022